

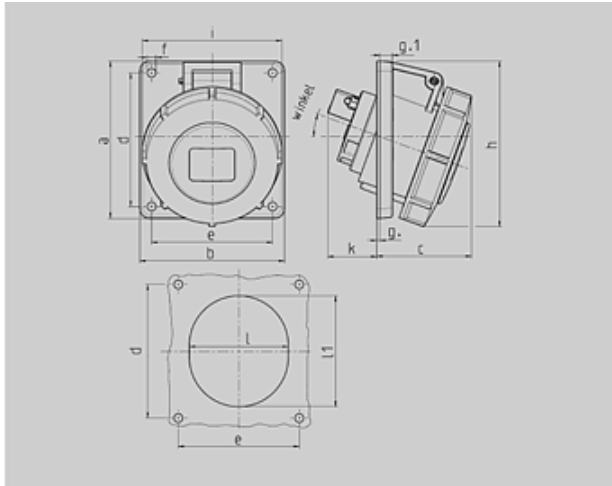

Part no. : 1506

Panel mounted receptacle

Drawing	Amp.	16			32		
		Poles			Poles		
1 MB 251		3	4	5	3	4	5
Dim. in mm							
	a	73,5	100	100	100	100	100
	b	64	92	92	92	92	92
	c	52	60	62	64	64	66
	d	60	85	85	85	85	85
	e	52	77	77	77	77	77
	f	5,5	5,5	5,5	5,5	5,5	5,5
	g	7	8	8	8	8	8
	h	2	2	2	2	2	2
	i	84	100	105	109	109	113
	j	78	85	96	103	103	110
	k	43	32	32	33	53	45
	l	52	55	65	67	67	72
	ll	60	63	72	82	82	85
	α	20°	20°	20°	20°	20°	20°
	Terminal for cond. cross section (mm²) min.-max.	1,5 -4	1,5 -4	1,5 -4	2,5 -10	2,5 -10	2,5 -10

Article-group : 1048

voltages : 400V

rated current : 32A

pole : 4 pole







IP protection types : IP67

position of ground contact : 6h

packing unit : 0010

weight : 280 g

PART NUMBERS

	V	110V	230V	400V	500V	>50-500V	
	Hz	50,60	50,60	50,60	50,60	100-300	300-500
	colour						
	amp.						
16 A	3	1474	1475	1476			
	4		1478	1479	1480	1481	
	5			1485			
32 A	3	1501	1502	1503			
	4		1505	1506	1507	1567	
	5			1551			